

CRAFT DISTON

Series 402-H Hinged Shower Enclosure

SPECIFICATIONS:

General: All aluminum enclosures shall be series No. 402-H as manufactured by Craft Fabricators, Ft. Scott, KS.

MATERIALS AND CONSTRUCTION:

Aluminum extrusions to be of 6063 T-5 alloy. Other screws to be rust resistant.

FINISH:

Silver - Polished Bright Dip Anodized.
Gold - Polished Bright Dip Gold Anodized.

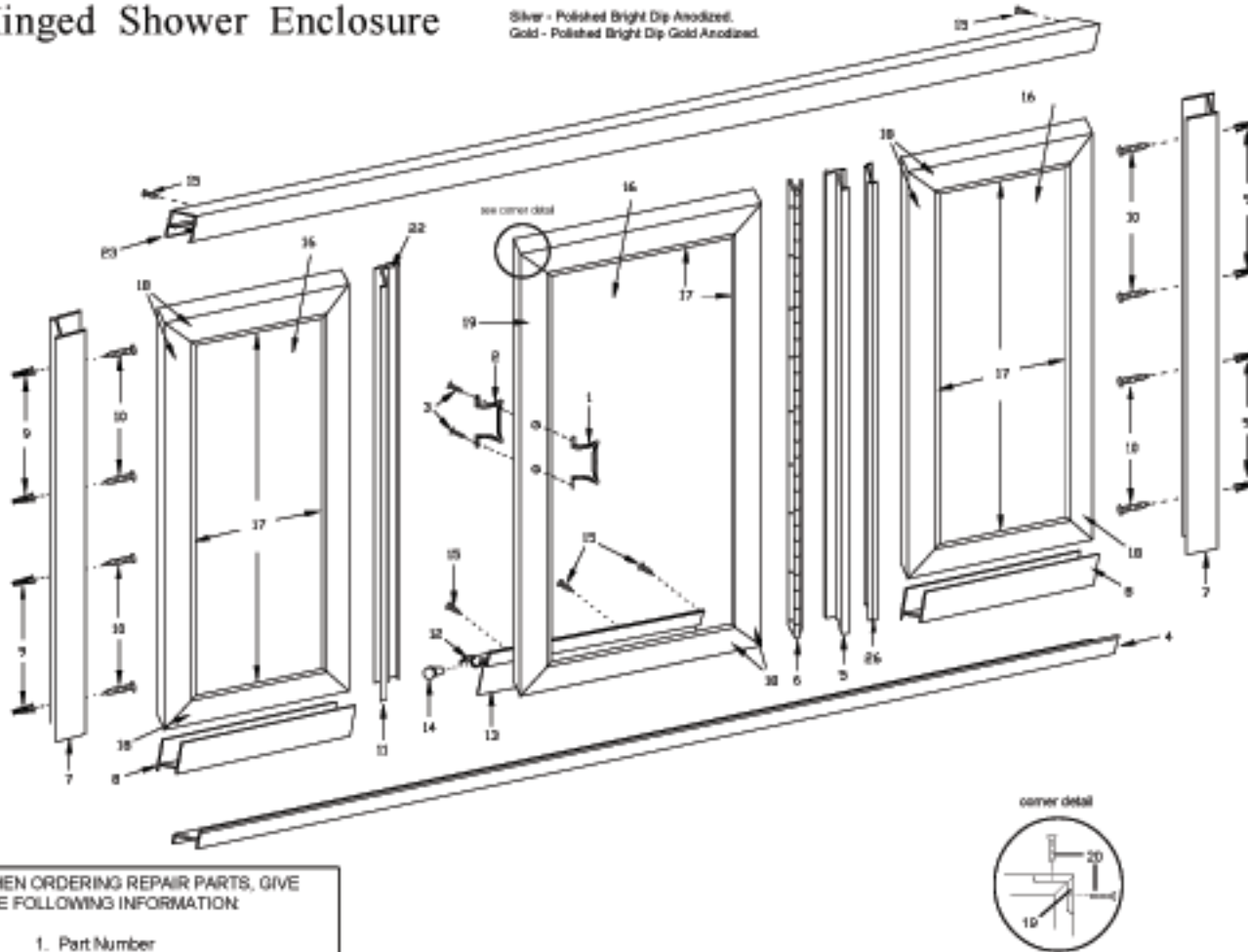

To install your shower enclosure, you will need the following:

- level
- 3/32", 1/8" and 3/16" drill bits
- phillips screwdriver
- sealant

| DESCRIPTION | QTY. | PART # | |
|---|--------|---------|--|
| 1. Outside (male) door handle | 1 | VPC-125 | |
| 2. Inside (female) door handle | 1 | VPC-125 | |
| 3. #8-32 x 5/8" flat head machine screws | 2 | | |
| 4. Threshold | 1 | CFM-70 | |
| 5. Hinge jamb | 1 | CFM-5 | |
| 6. Hinge | 1 | | |
| 7. Wall channels | 2 | CFM-53 | |
| 8. Sill channels | 2 | CFM-53 | |
| 9. Wall anchors | 6 | | |
| 10. #8 x 1 1/2" pan head sheet metal screws | 6 | | |
| 11. Strike jamb | 1 | CFM-84 | |
| 12. Drip channel | 1 | CFM-40 | |
| 13. Drip channel vinyl | 1 | 900 | |
| 14. Drip channel plug | 1 | 62M9012 | |
| 15. #6 x 3/8" pan head sheet metal screws | 3 | | |
| 16. Tempered glass (glass units) | 3 | 998 | |
| 17. Glazing vinyl | 48 ft. | 919 | |
| 18. Glass frames | 11 | CFM-1 | |
| 19. Magnetic glass frame | 1 | CFM-83 | |
| 20. Corner angles | 12 | 193-1-1 | |
| 21. #8-32 x 1/2" flat head machine screws | 24 | 301 | |
| 22. Magnetic strip | 1 | M-225 | |
| 23. Header | 1 | CFM-34 | |
| 24. #6 x 1/2" pan head sheet metal screws | 4 | | |
| 25. #6 x 3/4" oval head sheet metal screws | 4 | | |
| 26. Hinge jamb spacer | 1 | | |

WHEN ORDERING REPAIR PARTS, GIVE THE FOLLOWING INFORMATION:

1. Part Number
2. Part Name
3. Model Number
4. Specify design, if any

Step 1

SERIES 402-H

Assemble door handles

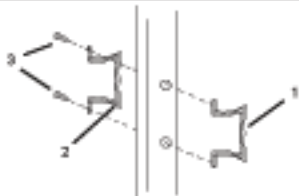

- attach outside (male) door handle (1) and inside (female) door handle (2) to door with two #6-32 x 5/8" flat head machine screws (3).
- set door assembly aside. (The inside door handle should be placed on the magnet side of the door.)

Step 2

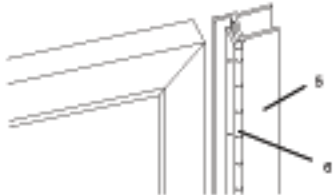

- this door is reversible and can swing to the right or left. (A right-swing door is shown.) Decide which way you wish your door to swing.

Step 3

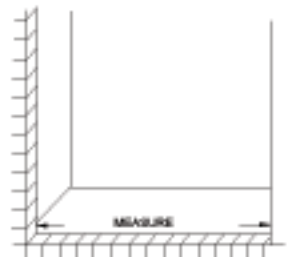

- measure the wall to wall opening of the shower curb.
- cut bottom threshold (4) 1/16" less than opening width.
Note: Make sure high side of threshold is to the outside of shower.

Step 4

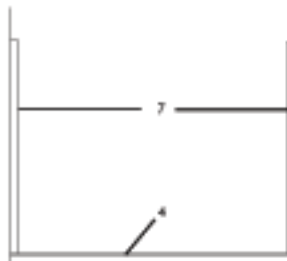

- position wall channels (7) on threshold (4), making sure threshold is centered on curb.
- plumb wall channels and mark installation holes on wall.
- remove all parts
- for ceramic tile installation, use a 3/16" masonry bit for drilling installation holes.
- install plastic wall anchors (8).
- for fiberglass installation, use a 1/8" drill bit for drilling installation holes.

Step 5

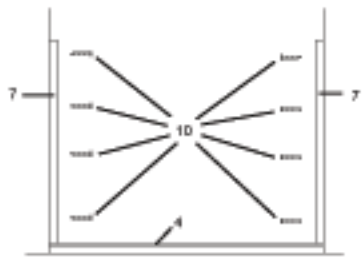

- place a bead of sealant on each end of curb under threshold location.
- replace threshold (4) on center of curb.
- replace wall channels (7) in previous location.
- secure wall channels to wall with three #6 x 1 1/2" truss head sheet metal screws (10).
- apply a liberal amount of sealant inside wall channels where wall channels meet threshold

Step 6

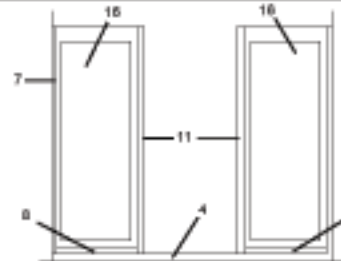

- cut sill channels (8) 3/4" less than glass panel width.
- attach sill channel to threshold by drilling 1/8" holes and using #8 x 1/2" pan head screws.
- set glass panels (16) into wall channels (7) and sill channels. Do not secure.
- attach strike jamb (11) to stationary glass panel by drilling 1/8" holes and using #8 x 1/2" flat head undercut screws.

Step 7



- position door on opposite panel
- attach door hinge jamb (with CFM-33 placed in back of hinge jamb) to panel using #8 x 3/4" oval head sheet metal screws (25).
- close door against strike jamb (11) making sure door is flush against jamb.
- measure the wall to wall opening across top of unit.
- cut header (23) 1/16" less than opening
- place header over wall channels.

Step 8

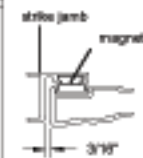
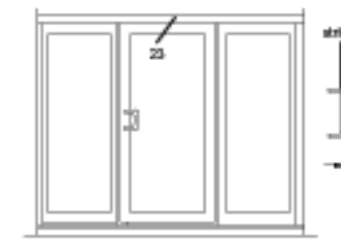

- adjust unit to opening.
- drill 3/32" holes in back of adjustable hinge jamb (5) and into wall channel (7).
- secure using three #6 x 3/8" pan head sheet metal screws.
- NOTE:** If magnet does not pull door shut, reverse strike jamb magnet. Groove in magnets should match.

Step 9

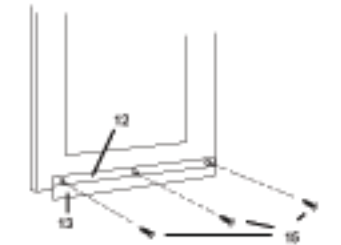

- cut drip channel (12) 1/4" less than panel width.
- notch drip channel 3/4" at hinge side to allow channel to overlap hinge jamb.
- using a file, round off both lower corners of drip channel.
- insert drip channel vinyl (13) into drip channel (12) and trim to size.
- insert plastic drip channel plug (14) into end of drip channel.
- with door closed, position drip channel on inside of door with a slope to the hinge side.
- mark the location, then clean door thoroughly with rubbing alcohol
- peel protective cover off double face tape and install drip channel.
- for additional security, drill three 3/32" holes from drip channel into door.
- secure with three #6 x 3/8" pan head machine screws (15).
- IMPORTANT:** holes must be drilled a minimum of 3/8" below exposed glass.

Step 10

- seal the inside and outside of the unit at any point unit meets wall or curb. Seal between outside of sill channel and high side of threshold.